

# JUNIOR ANCHOR BOX / SHOP SPACE - WILMINGTON, NC

5000 MARKET STREET | WILMINGTON, NORTH CAROLINA | 28405



**SITE**

## CONTACT

Matt Henry | 980.701.0034  
mhenry@providencegroup.com

Thurman Brooks | 704.644.4585  
tbrooks@providencegroup.com

Darrell Palasciano | 704.644.4587  
dpalasciano@providencegroup.com



**CLICK FOR VIDEO**



300 West Summit Ave | Suite 250 | Charlotte, North Carolina 28203  
www.PROVIDENCEGROUP.com

**AVAILABLE**  
FOR LEASE



# JUNIOR ANCHOR BOX / SHOP SPACE - WILMINGTON, NC

5000 MARKET STREET | WILMINGTON, NC | 28405

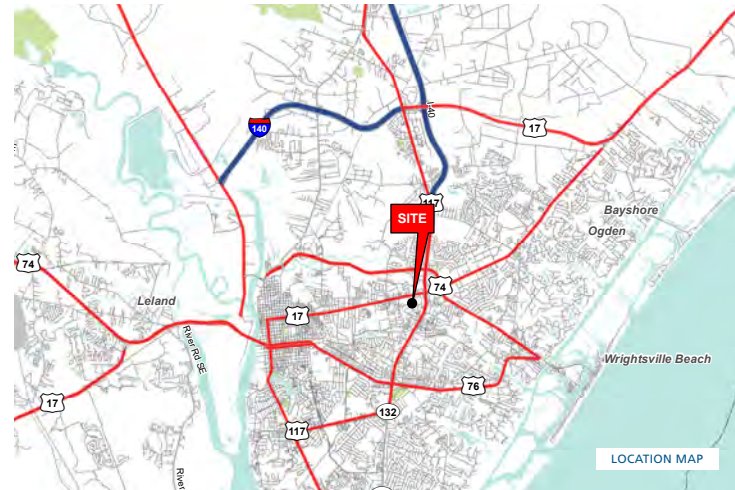

## PROPERTY / LEASING INFORMATION

Shopping Center GLA: 91,637 SF  
 Available Space: 1,931 - 38,549 SF  
 Lease Rate: Please Call  
 Zoning: RB (Regional Business)  
 TICAM: \$3.54 / SF

## PROPERTY HIGHLIGHTS

- Junior Anchor Opportunity on dynamic Wilmington retail corridor - Market Street
- Signalized Intersection at Lullwater Drive
- Wilmington ranked in top 10 in nation for economic growth (2023)
- Adjacent to Miller-Motte Technical college
- Fully built-out, conditioned classrooms/office space
- Space can be V-boxed for open use
- Close proximity to Costco, Target, Wal-mart, Academy Sports

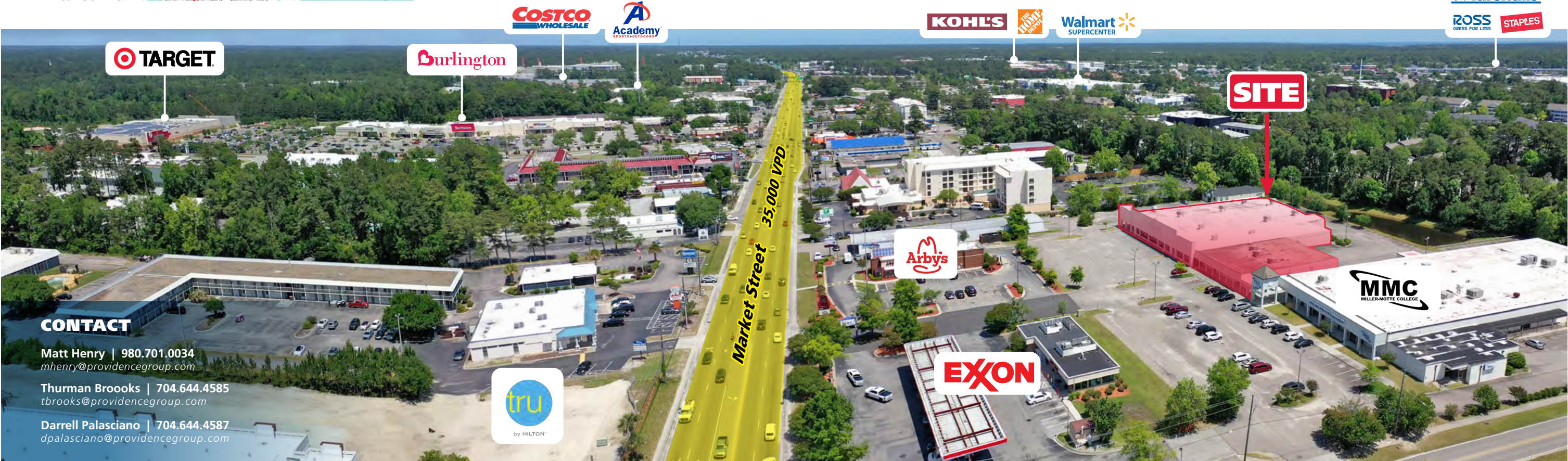

**CONTACT**  
 Matt Henry | 980.701.0034  
 mhenry@providencegroup.com  
 Thurman Brooks | 704.644.4585  
 tbrooks@providencegroup.com  
 Darrell Palasciano | 704.644.4587  
 dpalasciano@providencegroup.com

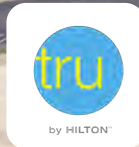

# JUNIOR ANCHOR BOX / SHOP SPACE - WILMINGTON, NC

5000 MARKET STREET | WILMINGTON, NC | 28405



DEMOGRAPHICS (2022)	1 MILE	3 MILE	5 MILE
POPULATION	10,116	62,315	140,381
AVERAGE HH INCOME	\$45,364	\$70,596	\$84,500
MEDIAN HH INCOME	\$36,015	\$53,114	\$62,645
BUSINESS ESTABLISHMENTS	739	4,241	9,849
DAYTIME EMPLOYMENT	8,158	44,757	94,674



**62,315**  
POPULATION\*



**27,752**  
ESTIMATED #  
HOUSEHOLDS\*



**\$70,596**  
AVERAGE  
HH INCOME\*



**4,241**  
TOTAL #  
BUSINESSES\*



**43.4%**  
BACHELOR/  
GRAD DEGREE\*

\* 3 MILE RADIUS

## CONTACT

**Matt Henry** | 980.701.0034  
mhenry@providencegroup.com

**Thurman Brooks** | 704.644.4585  
tbrooks@providencegroup.com

**Darrell Palasciano** | 704.644.4587  
dpalasciano@providencegroup.com

**\$2,136**  
MONTHLY RETAIL  
EXPENDITURE\*



© 2023 The Providence Group. All rights reserved. The information above has been obtained by sources deemed reliable. While we do not doubt its accuracy, we have not verified it and make no guarantee, warranty, or representation of it. It is your responsibility to independently confirm its accuracy and completeness. You and your advisors should conduct a careful, independent investigation of the property to determine to your satisfaction the suitability of the property for your needs.

# JUNIOR ANCHOR BOX / SHOP SPACE - WILMINGTON, NC

5000 MARKET STREET | WILMINGTON, NC | 28405

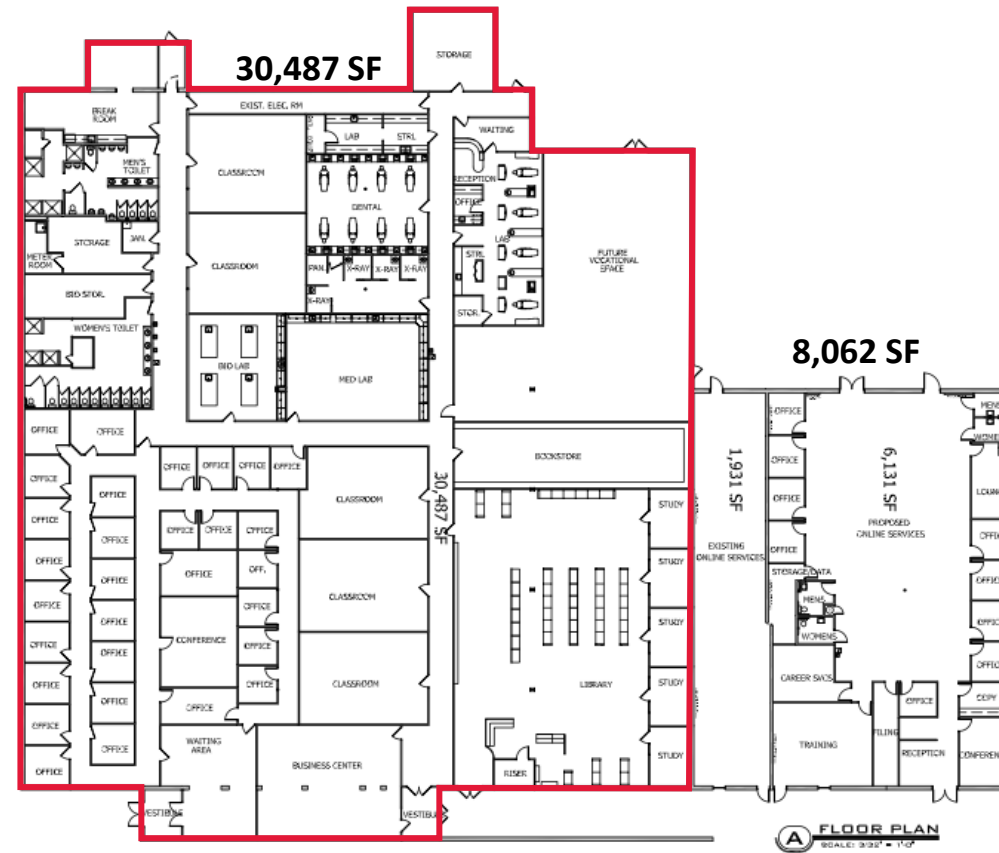

## CONTACT

**Matt Henry** | 980.701.0034  
mhenry@providencegroup.com

**Thurman Brooks** | 704.644.4585  
tbrooks@providencegroup.com

**Darrell Palasciano** | 704.644.4587  
dpalasciano@providencegroup.com

© 2023 The Providence Group. All rights reserved. The information above has been obtained by sources deemed reliable. While we do not doubt its accuracy, we have not verified it and make no guarantee, warranty, or representation of it. It is your responsibility to independently confirm its accuracy and completeness. You and your advisors should conduct a careful, independent investigation of the property to determine to your satisfaction the suitability of the property for your needs.





© 2023 The Providence Group. All rights reserved. The information above has been obtained by sources deemed reliable. While we do not doubt its accuracy, we have not verified it and make no guarantee, warranty, or representation of it. It is your responsibility to independently confirm its accuracy and completeness. You and your advisors should conduct a careful, independent investigation of the property to determine to your satisfaction the suitability of the property for your needs.

**CLICK FOR VIDEO**

**CONTACT**

**Matt Henry** | 980.701.0034  
mhenry@providencegroup.com

**Darrell Palasciano** | 704.644.4587  
dpalasciano@providencegroup.com